

CAPPUCCI E TAPPI CONICI IN POLIETILENE (SERIE T)

CODICE NO.	(A)		(B)		(C)		(D)		(E)		(F)		TAPPI da infilare in			CAPPUCCI da mettere sopra			SCATOLE DA			MINI-PAK
	in	mm	in	mm	in	mm	in	mm	in	mm	in	mm	NPT	STD	METRICO	NPT	STD	METRICO	pezzi	lbs	kgs	pezzi
IT .116/.182DR	.116	2.95	.182	4.62	.053	1.35	.120	3.05	.38	9.65	.31	7.87	~	~	~	~	~	~	5000	1	0.4	1000
IT .145/.205DR	.145	3.68	.205	5.21	.079	2.01	.150	3.81	.38	9.65	.41	10.41	~	~	~	~	~	~	5000	1	0.6	1000
IT .173/.240DR	.173	4.39	.240	6.10	.111	2.82	.177	4.50	.38	9.65	.38	9.65	~	1/4	M6	~	~	M3/M3.5	5000	2	0.7	1000
IT .236/.302DR	.236	5.99	.302	7.67	.174	4.42	.240	6.10	.38	9.65	.44	11.18	~	5/16	M8	~	~	M5	3000	1	0.6	600
IT .267/.335DR	.267	6.78	.335	8.51	.205	5.21	.273	6.93	.38	9.65	.47	11.94	~	~	~	~	~	M6	5000	2	1.0	1000
IT .299/.365DR	.299	7.59	.365	9.27	.235	5.97	.302	7.67	.38	9.65	.50	12.70	~	3/8	M10	~	5/16	M7	4000	2	1.0	800
IT .330/.396DR	.330	8.38	.396	10.06	.267	6.78	.333	8.46	.38	9.65	.53	13.46	1/8	~	~	~	~	~	3500	2	0.9	700
IT .361/.427DR	.361	9.17	.427	10.85	.298	7.57	.365	9.27	.38	9.65	.56	14.22	~	7/16	M12	~	~	M8	3000	2	0.9	600
IT .390/.456DR	.390	9.91	.456	11.58	.327	8.31	.394	10.01	.38	9.65	.59	14.99	~	~	M12	~	3/8	~	4500	3	1.4	900
IT .419/.485DR	.419	10.64	.485	12.32	.356	9.04	.422	10.72	.38	9.65	.63	16.00	1/4	1/2	M14	1/8	~	M10	4000	3	1.3	800
IT .447/.513DR	.447	11.35	.513	13.03	.385	9.78	.451	11.46	.38	9.65	.66	16.76	~	~	M14	~	7/16	~	3500	3	1.2	700
IT .471/.547DR	.471	11.96	.547	13.89	.409	10.39	.485	12.32	.44	11.18	.69	17.53	~	1/2	~	~	~	~	2500	2	1.1	500
IT .500/.576DR	.500	12.70	.576	14.63	.440	11.18	.516	13.11	.44	11.18	.72	18.29	~	~	M16	~	~	M12	5000	5	2.4	1000
IT .532/.608DR	.532	13.51	.608	15.44	.468	11.89	.545	13.84	.44	11.18	.75	19.05	~	5/8	~	1/4	~	~	4500	5	2.3	900
IT .550/.631DR	.550	13.97	.631	16.03	.487	12.37	.568	14.43	.47	11.94	.75	19.05	3/8	~	M18	~	9/16	~	4000	5	2.3	800
IT .580/.667DR	.580	14.73	.667	16.94	.518	13.16	.605	15.37	.50	12.70	.81	20.57	~	~	M18	~	5/8	M14	3000	4	2.0	600
IT .610/.695DR	.610	15.49	.695	17.65	.549	13.95	.634	16.10	.50	12.70	.84	21.34	~	~	~	~	~	~	3000	5	2.1	600
IT .640/.727DR	.640	16.26	.727	18.47	.578	14.68	.664	16.87	.50	12.70	.88	22.35	~	3/4	M20	~	~	~	2500	4	1.8	500
IT .675/.755DR	.675	17.15	.755	19.18	.613	15.57	.693	17.60	.50	12.70	.88	22.35	~	~	M20	3/8	~	M16	2500	4	1.8	500
IT .690/.788DR	.690	17.53	.788	20.02	.628	15.95	.726	18.44	.56	14.22	.94	23.88	1/2	~	M22	~	~	~	2000	4	1.7	400
IT .725/.823DR	.725	18.42	.823	20.91	.663	16.84	.761	19.33	.56	14.22	.97	24.64	~	~	M22	~	3/4	~	5000	10	4.7	1000
IT .750/.848DR	.750	19.05	.848	21.54	.687	17.45	.785	19.94	.56	14.22	1.00	25.40	~	3/8	M24	~	~	M18	5000	11	5.0	1000
IT .802/.911DR	.802	20.37	.911	23.14	.740	18.80	.849	21.57	.63	16.00	1.06	26.93	~	1/2	M24	1/2	~	~	5000	12	5.7	1000
IT .815/.930DR	.815	20.70	.930	23.62	.753	19.13	.868	22.05	.63	16.00	1.09	27.69	~	1	~	~	7/8	M20	5000	13	6.0	1000
IT .866/.975DR	.866	22.00	.975	24.77	.803	20.40	.912	23.17	.63	16.00	1.13	28.70	3/4	~	M27	~	~	~	5000	14	6.2	1000
IT .915/1.04DR	.915	23.24	1.040	26.42	.855	21.72	.980	24.89	.69	17.53	1.16	29.47	~	1 1/16	M27	~	~	M22	4300	14	6.1	860
IT .964/1.09DR	.964	24.49	1.090	27.69	.901	22.89	1.027	26.09	.75	19.05	1.25	31.75	~	~	~	3/4	~	M24	2500	9	4.0	500
IT .995/1.14DR	.995	25.27	1.145	29.08	.933	23.70	1.083	27.51	.75	19.05	1.31	33.28	~	~	M30	~	1 1/16	~	2500	10	4.6	500
IT 1.09/1.21DR	1.094	27.79	1.215	30.86	1.031	26.19	1.152	29.26	.75	19.05	1.41	35.82	1	1 1/4	M33	~	~	M27	2500	11	5.2	500
IT 1.17/1.28DR	1.175	29.85	1.284	32.61	1.113	28.27	1.222	31.04	.63	16.00	1.44	36.58	~	1 1/16	M33	~	~	~	2500	11	5.0	500
IT 1.22/1.35DR	1.224	31.09	1.355	34.42	1.161	29.49	1.292	32.82	.75	19.05	1.50	38.10	~	~	~	~	~	M30	1700	9	4.1	340
IT 1.23/1.36DR	1.235	31.37	1.360	34.55	1.173	29.80	1.298	32.97	.81	20.57	1.50	38.10	~	~	M36	1	1 1/16	~	1700	9	4.0	340
IT 1.31/1.46DR	1.312	33.33	1.465	37.21	1.249	31.73	1.402	35.61	.88	22.35	1.63	41.40	~	~	M39	~	~	M33	1500	9	4.3	300
IT 1.44/1.60DR	1.447	36.76	1.600	40.64	1.384	35.15	1.537	39.04	.88	22.35	1.75	44.45	1 1/4	1 1/16	~	~	~	M36	1000	7	3.1	200
IT 1.56/1.68DR	1.560	39.63	1.682	42.72	1.498	38.05	1.620	41.15	.75	19.05	1.88	47.75	~	1 1/8	~	1 1/4	1 1/8	M39	1000	7	3.2	200
IT 1.63/1.75DR	1.630	41.40	1.750	44.45	1.568	39.83	1.688	42.88	.75	19.05	1.94	49.28	~	~	~	~	~	~	1000	7	3.2	200
IT 1.75/1.88DR	1.750	44.45	1.880	47.75	1.688	42.88	1.818	46.18	.75	19.05	2.00	50.80	~	1 1/8	~	1 1/2	1 1/8	~	1000	8	3.5	200
IT 1.78/1.95DR	1.780	45.21	1.950	49.53	1.718	43.64	1.888	47.96	1.00	25.40	2.13	54.10	1 1/2	~	~	~	~	~	1000	10	4.3	200
IT 1.84/2.00DR	1.844	46.84	2.000	50.80	1.781	45.24	1.938	49.23	1.00	25.40	2.13	54.10	~	~	~	~	~	~	1000	10	4.6	200
IT 1.90/2.07DR	1.900	48.26	2.076	52.73	1.837	46.66	2.013	51.13	1.00	25.40	2.25	57.15	~	~	~	~	~	~	1000	11	4.8	200
IT 1.97/2.13DR	1.975	50.17	2.132	54.15	1.913	48.59	2.070	52.58	1.00	25.40	2.25	57.15	~	~	~	~	~	~	1000	11	5.0	200
IT 2.01/2.14DR	2.015	51.18	2.147	54.54	1.953	49.61	2.085	52.96	.75	19.05	2.31	58.68	~	2 1/4	~	~	~	~	1000	10	4.3	200
IT 2.06/2.24DR	2.067	52.50	2.243	56.97	2.005	50.93	2.181	55.40	1.00	25.40	2.44	61.98	~	~	~	2 1/4	~	~	1000	12	5.4	200
IT 2.13/2.31DR	2.136	54.26	2.312	58.73	2.074	52.68	2.250	57.15	1.00	25.40	2.56	65.03	~	2 1/2	~	~	2	~	500	6	2.8	100

Serie T

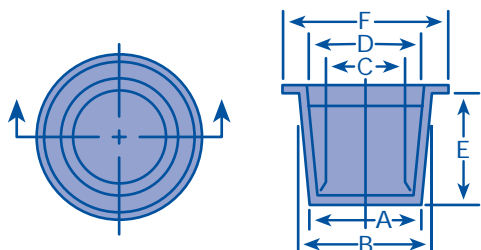

MOCAP si attrezza sempre con nuove misure. Chiamate l'ufficio vendite per informazioni.

TOLLERANZE PER TUTTE LE PARTI IN POLIETILENE:

Su tutte le Dimensioni a 1 Decimale ±.5 per 25mm (es: 25.0 per 25mm ±5mm minimo o 60.0 per 25mm = ±1.2mm)

Su tutte le Dimensioni a 2 Decimale ±.25 per 25mm (es: 25.00 ±.25 per 25mm = ±.25mm o 60.00 ±.25 per 25mm = ±.60mm)

COLORE STANDARD:



ALTRI COLORI DISPONIBILI



TAPPI da infilare in.

Per usare come un Tappo: Selezionare un Tappo con una dimensione "B" di almeno 0.5mm più larga del diametro da tappare (aumentare di 1% o più per grandi diametri).



CAPPUCCI da mettere sopra.

Per usare come Cappuccio: Selezionare un Cappuccio con una dimensione "C" di almeno 0.5mm più stretta del diametro da proteggere (aumentare di 1% o più per grandi diametri).