

## TAPPI A STILE LIVELLATO PER FOGLI DI METALLO (SERIE SMF)

CODICE NO.	DIMENSIONE FORE		SPESSORE METALLO		(A)		(B)		(C)		SCATOLE DA			MINI-PAK
	in	mm	in	mm	in	mm	in	mm	in	mm	pezzi	lbs	kg	pezzi
ISMF 3/8DB	.37-.38	9.40-9.65	.02-.06	0.51-1.52	.19	4.83	.75	19.05	.41	10.41	5000	6	2.2	1000
ISMF 7/16DB	.43-.45	10.97-11.43	.03-.06	0.76-1.52	.22	5.59	.69	17.53	.47	11.94	5000	7	3.1	1000
ISMF 1/2DB	.49-.52	12.45-13.08	.03-.08	0.76-2.03	.25	6.35	.86	21.84	.54	13.72	5000	7	3.1	1000
ISMF 9/16DB	.55-.58	14.00-14.66	.03-.08	0.76-2.03	.25	6.60	.87	22.09	.60	15.24	5000	7	3.1	1000
ISMF 5/8DB	.61-.64	15.49-16.13	.03-.08	0.76-2.03	.26	7.37	.81	20.57	.67	17.02	5000	7	3.1	1000
ISMF 3/4DB	.74-.77	18.67-19.43	.03-.11	0.76-2.79	.29	6.35	1.01	25.65	.79	20.07	5000	13	5.8	1000
ISMF 7/8DB	.86-.89	21.84-22.48	.03-.08	0.76-2.03	.25	6.35	1.16	29.46	.91	23.11	5000	16	7.2	1000
ISMF 15/16DB	.92-.96	23.42-24.26	.03-.08	0.76-2.03	.25	6.35	1.31	33.27	.98	24.89	5000	17	7.6	1000
ISMF 1DB	.96-1.02	24.38-25.78	.03-.08	0.76-2.03	.25	6.35	1.37	34.80	1.04	26.42	5000	20	9.0	1000
ISMF 1-3/16DB	1.17-1.20	29.59-30.48	.03-.08	0.76-2.03	.25	6.35	1.56	39.62	1.22	30.99	2500	12	5.4	500
ISMF 1-1/4DB	1.23-1.27	31.12-32.13	.03-.08	0.76-2.03	.25	6.35	1.62	41.15	1.29	32.77	2500	14	6.3	500
ISMF 1-5/16DB	1.30-1.33	32.89-33.78	.03-.08	0.76-2.03	.25	6.35	1.68	42.67	1.36	34.55	2500	14	6.3	500
ISMF 1-1/2DB	1.49-1.52	37.72-38.48	.03-.08	0.76-2.03	.25	6.35	1.88	47.75	1.54	39.12	2500	18	8.1	500

**MOCAP** si attrezza sempre con nuove misure. Chiamate l'ufficio vendite per informazioni.

SERIE SMF  
TESTA A LIVELLO

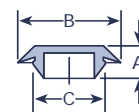
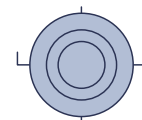

## TAPPI A STILE AD INCASSO PER FOGLI DI METALLO (SERIE SMR)

CODICE NO.	DIMENSIONE FORE		SPESSORE METALLO		(A)		(B)		(C)		SCATOLE DA			MINI-PAK
	in	mm	in	mm	in	mm	in	mm	in	mm	pezzi	lbs	kg	pezzi
ISMR 1/2DB	.50-.53	12.70-13.34	.02-.07	0.51-1.78	.29	7.37	.85	21.59	.55	13.97	5000	6	2.7	1000
ISMR 3/4DB	.74-.77	18.67-19.43	.02-.14	0.51-3.56	.36	9.14	1.16	29.47	.79	20.07	5000	13	5.8	1000
ISMR 13/16DB	.79-.83	20.17-20.96	.02-.07	0.51-1.78	.29	7.37	1.15	29.21	.85	21.59	5000	11	4.9	1000
ISMR 7/8DB	.87-.91	22.15-22.99	.02-.10	0.51-2.54	.35	8.89	1.23	31.24	.93	23.62	5000	13	5.8	1000
ISMR 1DB	.99-1.03	25.15-26.04	.02-.10	0.51-2.54	.35	8.89	1.35	34.29	1.05	26.67	5000	16	7.2	1000
ISMR 1-1/16DB	1.04-1.08	26.42-27.31	.02-.10	0.51-2.54	.35	8.89	1.40	35.56	1.10	27.94	5000	18	8.1	1000
ISMR 1-1/8DB	1.11-1.16	28.12-29.34	.02-.18	0.51-2.54	.43	10.92	1.53	38.86	1.18	29.97	2500	13	5.8	500
ISMR 1-1/4DB	1.24-1.28	31.37-32.39	.02-.10	0.51-2.54	.35	8.89	1.60	40.64	1.30	33.02	2500	13	5.8	500
ISMR 1-3/8DB	1.36-1.41	34.59-35.69	.02-.10	0.51-2.54	.35	8.89	1.73	43.94	1.43	36.32	2500	12	5.4	500
ISMR 1-1/2DB	1.48-1.53	37.59-38.74	.02-.10	0.51-2.54	.35	8.89	1.85	46.99	1.55	39.37	2500	15	6.8	500

**MOCAP** si attrezza sempre con nuove misure. Chiamate l'ufficio vendite per informazioni.

SERIE SMR  
TESTA AD INCASTRO

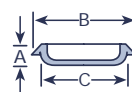
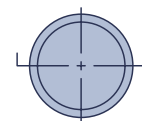

COLORE  
STANDARD:



ALTRI COLORI DISPONIBILI